

Benjamin Sheridan Soldered Valve & Cartridge Valve Repair Instructions

Instructions are for both kits except where indicated

1. Remove stock assembly from action/barrel assembly by removing the receiver stock screw #12.

2. In order to replace the rubber piston head #5 you must first remove the piston rod assembly #6. To do this, the roll pins #2 must be tapped out and the muzzle cap #1 removed. Now, you can line up the pin holding the pump handle in with the roll pin hole and punch that out too #4. Now remove the piston rod and pull the old rubber piston head off and replace with new rubber piston head. Do not reassemble until you have completed steps 3 or 4.

**Next step is to remove the valve assembly.
For Soldered Valve follow step 3.
For Cartridge Valve follow step 4.**

**3. Remove the retaining cap assembly #40. It is located at the back of the action behind breech. Once you have removed this cap you will be able to remove the spring, guide and hammer (#32,#33 and #34) to access the tube and remove your valve assembly. For the Soldered Valve you need to insert the square end of the metal valve tool (supplied with the kit) into the tube. It will fit into the valve guide retaining nut #29. Unscrew this nut. Once unscrewed and removed, flip tool over and thread the end over the valve guide #28 and use wrench to pull guide and assembly out of tube. You can now replace old parts with new. The parts in your kit have been circled on the drawing. They are #30,#23,#31,#27*,#5 #19.
#30 needs to be inserted in so the rubber is facing the muzzle end.**

4. Remove the retaining cap assembly, it is located at the back of the tube behind the breech. Once you have removed this cap, you will be able to remove the spring, guide and hammer (#32,#33 and #34) to access the air chamber and remove your valve assembly. The Cartridge Valve assembly #9 is one piece. The stock retaining nut and screw holds it in. It can be removed by taking out that screw and pushing it out of the back of the tube where the retaining cap was removed, using a dowel or rod. Once you have removed the valve assembly, you can replace the appropriate parts.

5. After all parts have been replaced you can reassemble your rifle.

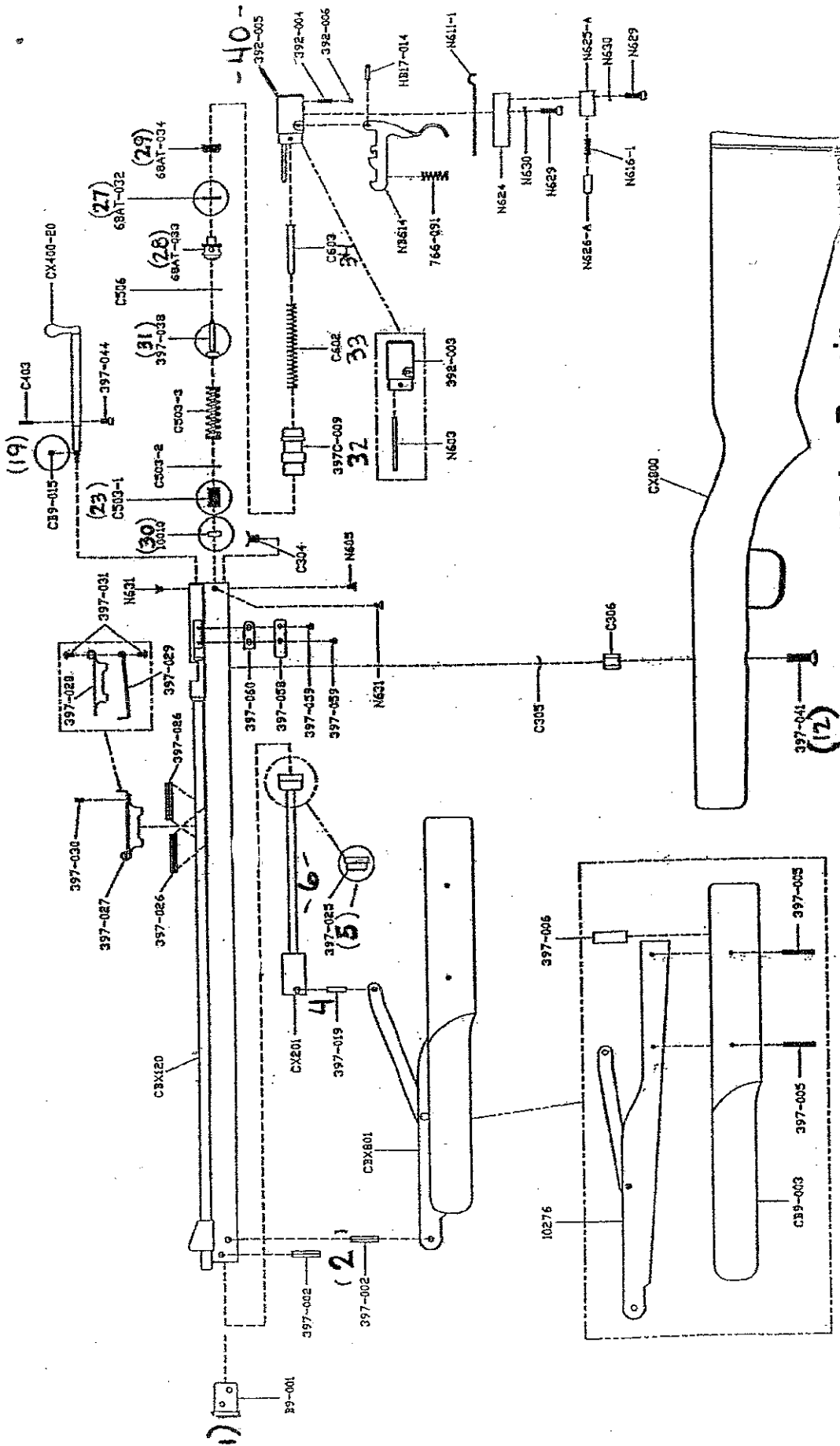

Soldered Valve Repair

*White plastic split ring replaces the lead washer if needed.

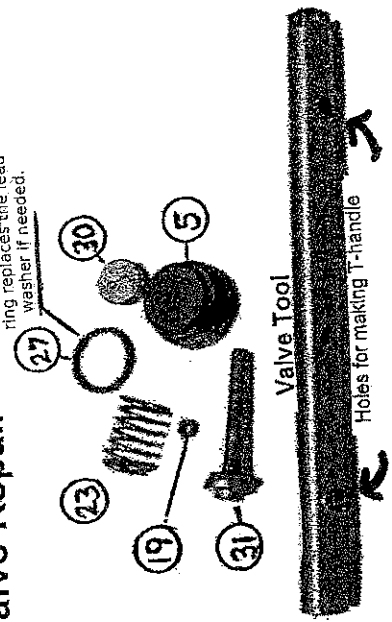

Cartridge Valve Repair

